

## YG-1 TOOLING SYSTEM

# SYNCHRO TAPPING CHUCK

- SYNCHRO GEWINDESCHNEIDFUTTER
- SYNCHRO TARAUDER
- SINCRO MANDRINI PER MASCHIATURA
- SINCRO PORTAMACHOS



### SYNCHRO TAPPING CHUCK (ER TYPE)

DIN 69871-SK

DIN 69893/ISO 12164-1-HSK

JIS B6339/MAS 403-BT

STRAIGHT-K

### SYNCHRO TAPPING CHUCK (QUICK CHANGE TYPE)

DIN 69871-SK

DIN 69893/ISO 12164-1-HSK

STRAIGHT-K

SYNCHRO TAPPING CHUCK (ER TYPE)

SYTER

SYNCHRO GEWINDESCHNEIDFUTTER (ER)  
 SYNCHRO TARAUDER (ER)  
 SINCR0 MANDRINI PER MASCHIATURA (ER)  
 SINCR0 PORTAMACHOS (ER)

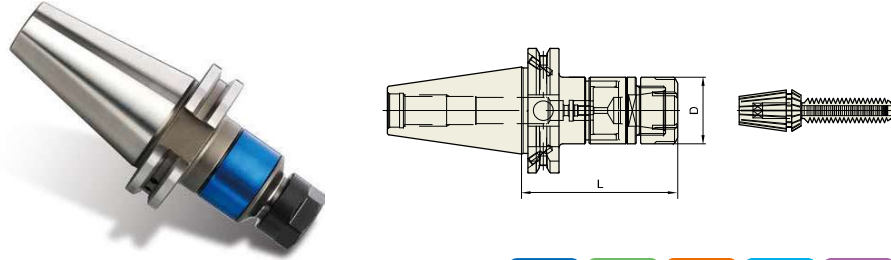

|                  |                       |              |          |                        |
|------------------|-----------------------|--------------|----------|------------------------|
| DIN 69871<br>-SK | Taper Accuracy<br>AT3 | G Value<br>- | RPM<br>- | Coolant System<br>AD/B |
|------------------|-----------------------|--------------|----------|------------------------|

■ DIN 69871-SK

Unit : mm

| TAPER No. | MODEL No.            | EDP No.  | TAP SIZE | CLAMPING RANGE | NUT  | D  | L   | WEIGHT (Kg) |
|-----------|----------------------|----------|----------|----------------|------|----|-----|-------------|
| 40        | SK40AD/B-SYTER12-79  | P2773701 | M2-M8    | 3.0 - 6.2      | ER16 | 28 | 79  |             |
|           | SK40AD/B-SYTER16-85  | P2773702 | M3-M10   | 4.0 - 7.0      | ER20 | 34 | 85  |             |
|           | SK40AD/B-SYTER20-90  | P2773703 | M3-M14   | 4.0 - 10.5     | ER25 | 42 | 90  |             |
|           | SK40AD/B-SYTER27-100 | P2773704 | M4-M18   | 5.0 - 14.0     | ER32 | 50 | 100 |             |
| 50        | SK40AD/B-SYTER33-120 | P2773705 | M8-M24   | 6.2 - 19.0     | ER40 | 63 | 120 |             |
|           | SK50AD/B-SYTER12-79  | P2773706 | M2-M8    | 3.0 - 6.2      | ER16 | 28 | 79  |             |
|           | SK50AD/B-SYTER16-85  | P2773707 | M3-M10   | 4.0 - 7.0      | ER20 | 34 | 85  |             |
|           | SK50AD/B-SYTER20-90  | P2773708 | M3-M14   | 4.0 - 10.5     | ER25 | 42 | 90  |             |
|           | SK50AD/B-SYTER27-100 | P2773709 | M4-M18   | 5.0 - 14.0     | ER32 | 50 | 100 |             |
|           | SK50AD/B-SYTER33-105 | P2773710 | M8-M24   | 6.2 - 19.0     | ER40 | 63 | 105 |             |

- ▶ Feature :
  - To compensate for synchronization errors to extend tap life and to improve thread quality
  - To compensate for pitch tolerances of taps
  - For machine with synchronized spindle
- ▶ CAT(ANSI B5.50) taper and Inch type products are available.
- ▶ ER collet of page 95~97, and Tap ER collet of page 98~99 are applicable.

SYNCHRO TAPPING CHUCK (ER TYPE)

SYTER

SYNCHRO GEWINDESCHNEIDFUTTER (ER)  
 SYNCHRO TARAUDER (ER)  
 SINCR0 MANDRINI PER MASCHIATURA (ER)  
 SINCR0 PORTAMACHOS (ER)

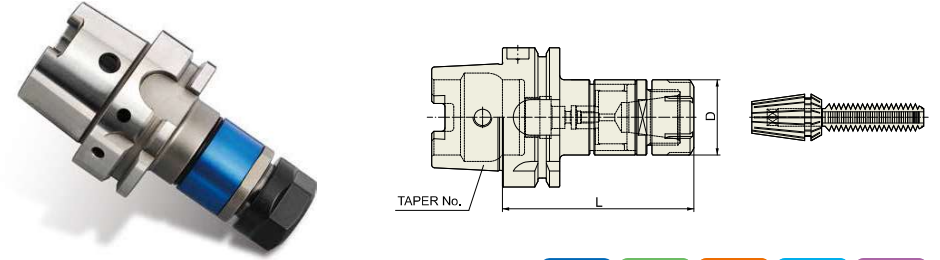

|                   |                     |              |          |                      |
|-------------------|---------------------|--------------|----------|----------------------|
| DIN 69893<br>-HSK | Taper Accuracy<br>- | G Value<br>- | RPM<br>- | Coolant System<br>AD |
|-------------------|---------------------|--------------|----------|----------------------|

■ DIN 69893/ISO 12164-1-HSK FORM A

Unit : mm

| TAPER No. | MODEL No.          | EDP No.  | TAP SIZE | CLAMPING RANGE | NUT  | D  | L   | WEIGHT (Kg) |
|-----------|--------------------|----------|----------|----------------|------|----|-----|-------------|
| 63A       | HSK63A-SYTER16-90  | P2773801 | M3-M10   | 4.0 - 7.0      | ER20 | 34 | 90  |             |
|           | HSK63A-SYTER20-94  | P2773802 | M3-M14   | 4.0 - 10.5     | ER25 | 42 | 94  |             |
|           | HSK63A-SYTER27-105 | P2773803 | M4-M18   | 5.0 - 14.0     | ER32 | 50 | 105 |             |

- ▶ Feature :
  - To compensate for synchronization errors to extend tap life and to improve thread quality
  - To compensate for pitch tolerances of taps
  - For machine with synchronized spindle
- ▶ ER collet of page 95~97, and Tap ER collet of page 98~99 are applicable.

SYNCHRO TAPPING CHUCK (ER TYPE)

SYTER

SYNCHRO GEWINDESCHNEIDFUTTER (ER)  
 SYNCHRO TARAUDER (ER)  
 SINCRO MANDRINI PER MASCHIATURA (ER)  
 SINCRO PORTAMACHOS (ER)

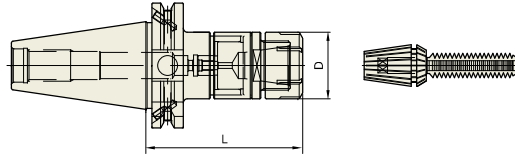

|                  |                       |              |          |                        |
|------------------|-----------------------|--------------|----------|------------------------|
| JIS B6339<br>-BT | Taper Accuracy<br>AT3 | G Value<br>- | RPM<br>- | Coolant System<br>AD/B |
|------------------|-----------------------|--------------|----------|------------------------|

JIS B6339/MAS 403-BT

Unit : mm

| TAPER No. | MODEL No.            | EDP No.  | TAP SIZE | CLAMPING RANGE | NUT  | D  | L   | WEIGHT (Kg) |
|-----------|----------------------|----------|----------|----------------|------|----|-----|-------------|
| 40        | BT40AD/B-SYTER12-79  | P2776301 | M2-M8    | 3.0 - 6.2      | ER16 | 28 | 79  |             |
|           | BT40AD/B-SYTER16-85  | P2776302 | M3-M10   | 4.0 - 7.0      | ER20 | 34 | 85  |             |
|           | BT40AD/B-SYTER20-90  | P2776303 | M3-M14   | 4.0 - 10.5     | ER25 | 42 | 90  |             |
|           | BT40AD/B-SYTER27-100 | P2776304 | M4-M18   | 5.0 - 14.0     | ER32 | 50 | 100 |             |
| 50        | BT40AD/B-SYTER33-125 | P2776305 | M8-M24   | 6.2 - 19.0     | ER40 | 63 | 125 |             |
|           | BT50AD/B-SYTER12-100 | P2776306 | M2-M8    | 3.0 - 6.2      | ER16 | 28 | 100 |             |
|           | BT50AD/B-SYTER16-100 | P2776307 | M3-M10   | 4.0 - 7.0      | ER20 | 34 | 100 |             |
|           | BT50AD/B-SYTER20-100 | P2776308 | M3-M14   | 4.0 - 10.5     | ER25 | 42 | 100 |             |
|           | BT50AD/B-SYTER27-110 | P2776309 | M4-M18   | 5.0 - 14.0     | ER32 | 50 | 110 |             |
|           | BT50AD/B-SYTER33-125 | P2776310 | M8-M24   | 6.2 - 19.0     | ER40 | 63 | 125 |             |

- ▶ Feature :
- To compensate for synchronization errors to extend tap life and to improve thread quality
  - To compensate for pitch tolerances of taps
  - For machine with synchronized spindle
- ▶ ER collet of page 95~97, and Tap ER collet of page 98~99 are applicable.

SYNCHRO TAPPING CHUCK (ER TYPE)

SYTER

SYNCHRO GEWINDESCHNEIDFUTTER (ER)  
 SYNCHRO TARAUDER (ER)  
 SINCRO MANDRINI PER MASCHIATURA (ER)  
 SINCRO PORTAMACHOS (ER)

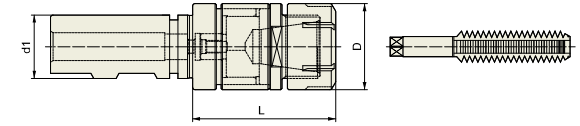

STRAIGHT-K

Unit : mm

| MODEL No.   | EDP No.  | TAP SIZE | CLAMPING RANGE | NUT / COLLET | D  | L  | d1 | WEIGHT (Kg) |
|-------------|----------|----------|----------------|--------------|----|----|----|-------------|
| K20-SYTER16 | P2773901 | M3-M10   | 4.0 - 7.0      | ER20         | 34 | 58 | 20 |             |
| K25-SYTER16 | P2773902 | M3-M10   | 4.0 - 7.0      | ER20         | 34 | 61 | 25 |             |
| K25-SYTER27 | P2773903 | M4-M18   | 5.0 - 14.0     | ER32         | 50 | 69 | 25 |             |

- ▶ Feature :
- To compensate for synchronization errors to extend tap life and to improve thread quality
  - To compensate for pitch tolerances of taps
  - For machine with synchronized spindle
- ▶ ER collet of page 95~97, and Tap ER collet of page 98~99 are applicable.

SYNCHRO TAPPING CHUCK (QUICK CHANGE TYPE)

SYTC

SYNCHRO GEWINDESCHNEID-SCHNELLWECHSELFUTTER  
 SYNCHRO TARAUDER À CHANGEMENT RAPIDE  
 SINCRIO MANDRINO PER MASCHIARE  
 SINCRIO PORTAMACHOS DE CAMBIO RAPIDO

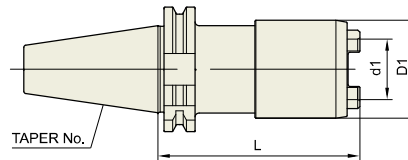

|               |                    |           |       |                  |
|---------------|--------------------|-----------|-------|------------------|
| DIN 69871 -SK | Taper Accuracy AT3 | G Value - | RPM - | Coolant System A |
|---------------|--------------------|-----------|-------|------------------|

■ DIN 69871-SK

Unit : mm

| TAPER No. | MODEL No.       | EDP No.  | TAP SIZE | MATCHING INSERTS | d1 | D1 | L   | WEIGHT (Kg) |
|-----------|-----------------|----------|----------|------------------|----|----|-----|-------------|
| 30        | SK30-SYTC12-65  | P2774207 | M3-M12   | 1                | 19 | 36 | 65  | 0.50        |
|           | SK30-SYTC20-89  | P2774208 | M6-M24   | 2                | 31 | 50 | 89  | 1.00        |
| 40        | SK40-SYTC12-65  | P2774201 | M3-M12   | 1                | 19 | 36 | 65  | 1.10        |
|           | SK40-SYTC20-79  | P2774202 | M6-M24   | 2                | 31 | 50 | 79  | 1.50        |
|           | SK40-SYTC33-115 | P2774203 | M18-M38  | 3                | 48 | 74 | 115 | 3.30        |
| 50        | SK50-SYTC12-65  | P2774204 | M3-M12   | 1                | 19 | 36 | 65  | 3.00        |
|           | SK50-SYTC20-79  | P2774205 | M6-M24   | 2                | 31 | 50 | 79  | 3.30        |
|           | SK50-SYTC33-115 | P2774206 | M18-M38  | 3                | 48 | 74 | 115 | 5.20        |

- Feature :
- To compensate for synchronization errors to extend tap life and to improve thread quality
  - To compensate for pitch tolerances of taps
  - For machine with synchronized spindle
- CAT(ANSI B5.50) taper and Inch type products are available.
- For applicable Tap Adapter, please refer to page 195~196.

SYNCHRO TAPPING CHUCK (QUICK CHANGE TYPE)

SYTC

SYNCHRO GEWINDESCHNEID-SCHNELLWECHSELFUTTER  
 SYNCHRO TARAUDER À CHANGEMENT RAPIDE  
 SINCRIO MANDRINO PER MASCHIARE  
 SINCRIO PORTAMACHOS DE CAMBIO RAPIDO

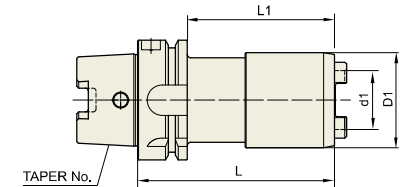

|                |                  |           |       |                  |
|----------------|------------------|-----------|-------|------------------|
| DIN 69893 -HSK | Taper Accuracy - | G Value - | RPM - | Coolant System A |
|----------------|------------------|-----------|-------|------------------|

■ DIN 69893/ISO 12164-1-HSK FORM A

Unit : mm

| TAPER No. | MODEL No.          | EDP No.  | TAP SIZE | MATCHING INSERTS | d1 | D1 | L   | L1  | WEIGHT (Kg) |
|-----------|--------------------|----------|----------|------------------|----|----|-----|-----|-------------|
| 32A       | HSK32A-SYTC12-75   | P2774314 | M3-M12   | 1                | 19 | 36 | 75  | 55  |             |
| 50A       | HSK50A-SYTC12-72   | P2774315 | M3-M12   | 1                | 19 | 36 | 72  | 46  |             |
|           | HSK50A-SYTC20-91   | P2774316 | M6-M24   | 2                | 31 | 50 | 91  | 65  |             |
| 63A       | HSK63A-SYTC12-75   | P2774301 | M3-M12   | 1                | 19 | 36 | 75  | 49  |             |
|           | HSK63A-SYTC12-80   | P2774302 | M3-M12   | 1                | 19 | 36 | 80  | 54  |             |
|           | HSK63A-SYTC12-120  | P2774303 | M3-M12   | 1                | 19 | 36 | 120 | 94  |             |
|           | HSK63A-SYTC12-152  | P2774304 | M3-M12   | 1                | 19 | 36 | 152 | 126 |             |
|           | HSK63A-SYTC12-180  | P2774305 | M3-M12   | 1                | 19 | 36 | 180 | 154 |             |
|           | HSK63A-SYTC20-89   | P2774306 | M6-M24   | 2                | 31 | 50 | 89  | 63  |             |
| 100A      | HSK63A-SYTC33-121  | P2774307 | M18-M38  | 3                | 48 | 74 | 121 | 95  |             |
|           | HSK100A-SYTC12-75  | P2774308 | M3-M12   | 1                | 19 | 36 | 75  | 43  |             |
|           | HSK100A-SYTC12-160 | P2774309 | M3-M12   | 1                | 19 | 36 | 160 | 131 |             |
|           | HSK100A-SYTC20-94  | P2774310 | M6-M24   | 2                | 31 | 50 | 94  | 65  |             |
|           | HSK100A-SYTC20-160 | P2774311 | M6-M24   | 2                | 31 | 50 | 160 | 131 |             |
|           | HSK100A-SYTC33-127 | P2774312 | M18-M38  | 3                | 48 | 74 | 127 | 98  |             |
|           | HSK100A-SYTC33-160 | P2774313 | M18-M38  | 3                | 48 | 74 | 160 | 131 |             |

- Feature :
- To compensate for synchronization errors to extend tap life and to improve thread quality
  - To compensate for pitch tolerances of taps
  - For machine with synchronized spindle
- For applicable Tap Adapter, please refer to page 195~196.

## SYNCHRO TAPPING CHUCK (QUICK CHANGE TYPE)

**SYTC**

SYNCHRO GEWINDESCHNEID-SCHNELLWECHSELFUTTER  
 SYNCHRO TARAUDER À CHANGEMENT RAPIDE  
 SINCRÒ MANDRINO PER MASCHIARE  
 SINCRÒ PORTAMACHOS DE CAMBIO RAPIDO

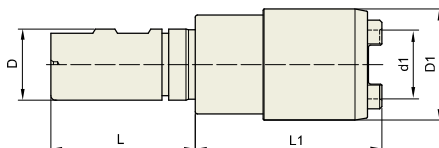

### STRAIGHT-K

Unit : mm

| TAPER No. | MODEL No.        | EDP No.  | TAP SIZE | MATCHING INSERTS | d1 | D1 | L  | L1    | D  | WEIGHT (Kg) |
|-----------|------------------|----------|----------|------------------|----|----|----|-------|----|-------------|
| 20        | K20-SYTC12-46    | P2774401 | M3-M12   | 1                | 19 | 36 | 50 | 46    | 20 |             |
|           | K20-SYTC12-107.5 | P2774406 | M3-M12   | 1                | 19 | 36 | 50 | 107.5 | 20 |             |
| 25        | K25-SYTC12-46    | P2774402 | M3-M12   | 1                | 19 | 36 | 56 | 46    | 25 |             |
|           | K25-SYTC20-74    | P2774403 | M6-M24   | 2                | 31 | 50 | 56 | 74    | 25 |             |
|           | K25-SYTC33-107.5 | P2774404 | M18-M38  | 3                | 48 | 74 | 56 | 107.5 | 25 |             |
| 32        | K32-SYTC12-74    | P2774405 | M3-M12   | 1                | 31 | 50 | 60 | 74    | 32 |             |

- ▶ **Feature :**
  - To compensate for synchronization errors to extend tap life and to improve thread quality
  - To compensate for pitch tolerances of taps
  - For machine with synchronized spindle
- ▶ For applicable Tap Adapter, please refer to page 195~196.